

Door Lock Connections

1. Internal Power Supply Mode

Use the power of the system to supply for the electronic lock, so that the lock can be connected to the door station directly, without an additional power supply for the electronic lock. Note that the door station can only output 12Vdc power, therefore the kind of lock is limited.

- The rated power of the lock must be less than 12Vdc 300mA when using internal power supply mode
- The GND must connect to the negative of the lock, and the COM connect to the positive .
- Jumper set to 2-3 position for Power-off-to-Unlock safety type(*Normally closed mode*); set to 1-2 position for Power-on-to -Unlock type(*Normally open mode*).
- If different unlocking time is needed to be configured, the ST-CONFIG software can be used to change the *Unlock Timing* on the *Parameter* tab(for more detail information ,please refer to ST-CONFIG software user manual).

A. Connection for Power-on-to-Unlock type:

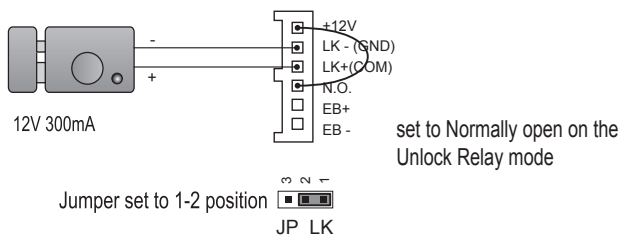

B. Connection for Power-off-to-Unlock type:

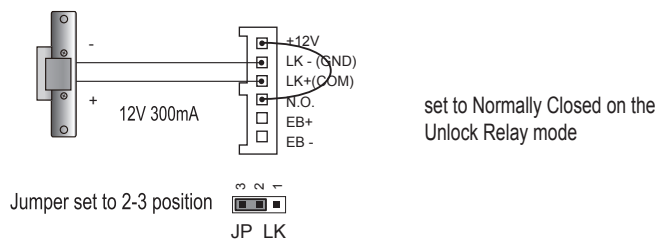

2. External Power Supply Mode

When the electronic lock is over 12 Vdc, additional power supply for the lock is needed.

- The power supply for the lock must be less than 48Vdc 1.5A.
- The Jumper must be removed when using external power supply. The default setting is Power-on-to-Unlock type(*Normally open mode*), if use Power-off-to-Unlock type, change the Unlock Relay mode to *Normally closed mode* .
- If different unlocking time is needed to be configured, the ST-CONFIG software can be used to change the *Unlock Timing* on the *Parameter* tab(for more detail information ,please refer to ST-CONFIG software user manual).

C. Connection for Power-to-Unlock type:

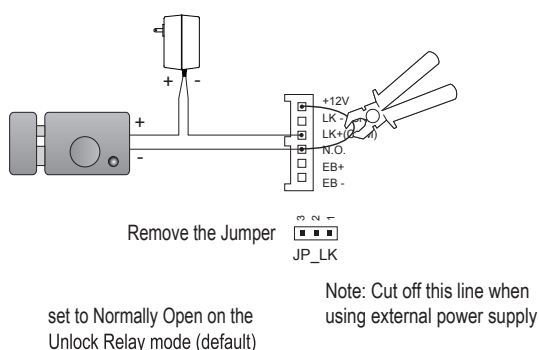

D. Connection for Power-off-to-Unlock type:

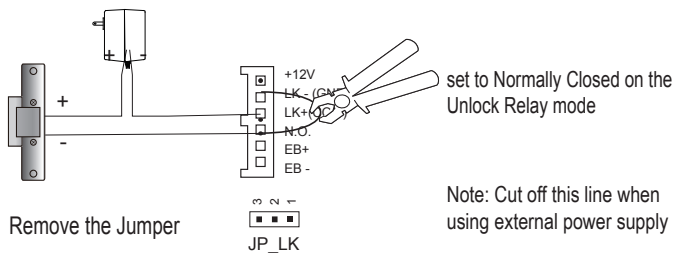

www.sambo.gr
 Γρुπάρη 56 Καλλιθέα ,Αθήνα
 Τηλ. 2109512191 - 2109588732
 Fax : 2109588732
 Email :info@sambo.gr